



Mi Universidad

Nombre del Alumno: Osvaldo López Velasco

Nombre del tema: ingles ejercicios

Parcial: 4

Nombre de la Materia: ingles11

Nombre del profesor: Rafael Ivan Guillen Alcala

Nombre de la Licenciatura: Medicina veterinaria y zootecnia

Cuatrimestre:2

Places

A Complete these sentences with the correct places.

Write one letter on each line.

- We need gasoline for the car. Is there a g a s s t a t i o n near here?
- I'm going to go to the B A N K. I need some traveler's checks.
- I work at a B O O K S T O R E. I love books, so it's a great job.
- Are you going to the P O S T O F F I C E? I need some stamps.
- We don't have anything for dinner. Let's buy some food at the S U P E R M A R K E T.
- Tomorrow we're going to go to Paris for five days. We're going to stay at an expensive H O T E L.
- I have a stomachache. Can you buy some antacid at the D R U G S T O R E?
- Let's go out for lunch. There's a great Mexican R E S T A U R A N T downtown.

B Find and circle the places in part A in the puzzle.

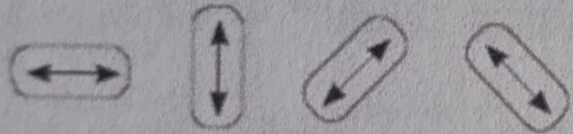

P	H	K	T	Y	W	X	D	C	H	B	S	S	R
D	O	A	W	O	J	R	P	T	O	O	Y	R	E
F	M	S	J	D	R	U	G	S	T	O	R	E	S
S	C	K	T	F	U	Z	V	N	E	K	T	M	T
N	P	W	O	O	H	Y	P	R	L	S	E	L	A
S	K	P	U	K	F	N	S	A	Q	T	N	X	U
K	N	I	B	Y	S	F	U	Y	W	O	M	I	R
G	A	S	S	T	A	T	I	O	N	R	V	G	A
E	B	L	F	W	G	P	C	C	M	E	A	O	N
S	U	P	E	R	M	A	R	K	E	T	K	G	T



2

Look at the map. Complete the sentences with the prepositions in the box.

- | | | |
|--------------------------------------|----------------------------------|---|
| <input type="checkbox"/> across from | <input type="checkbox"/> between | <input checked="" type="checkbox"/> on |
| <input type="checkbox"/> behind | <input type="checkbox"/> next to | <input type="checkbox"/> on the corner of |

- The English school is on Catherine Street.
- The hospital is behind the hotel.
- The Mexican restaurant is on the corner of Beatrice Street and Fourth Avenue.
- The bank is on Barbara Street, between Sixth and Seventh Avenues.
- The bookstore is next to the English school.
- The coffee shop is across from the park.

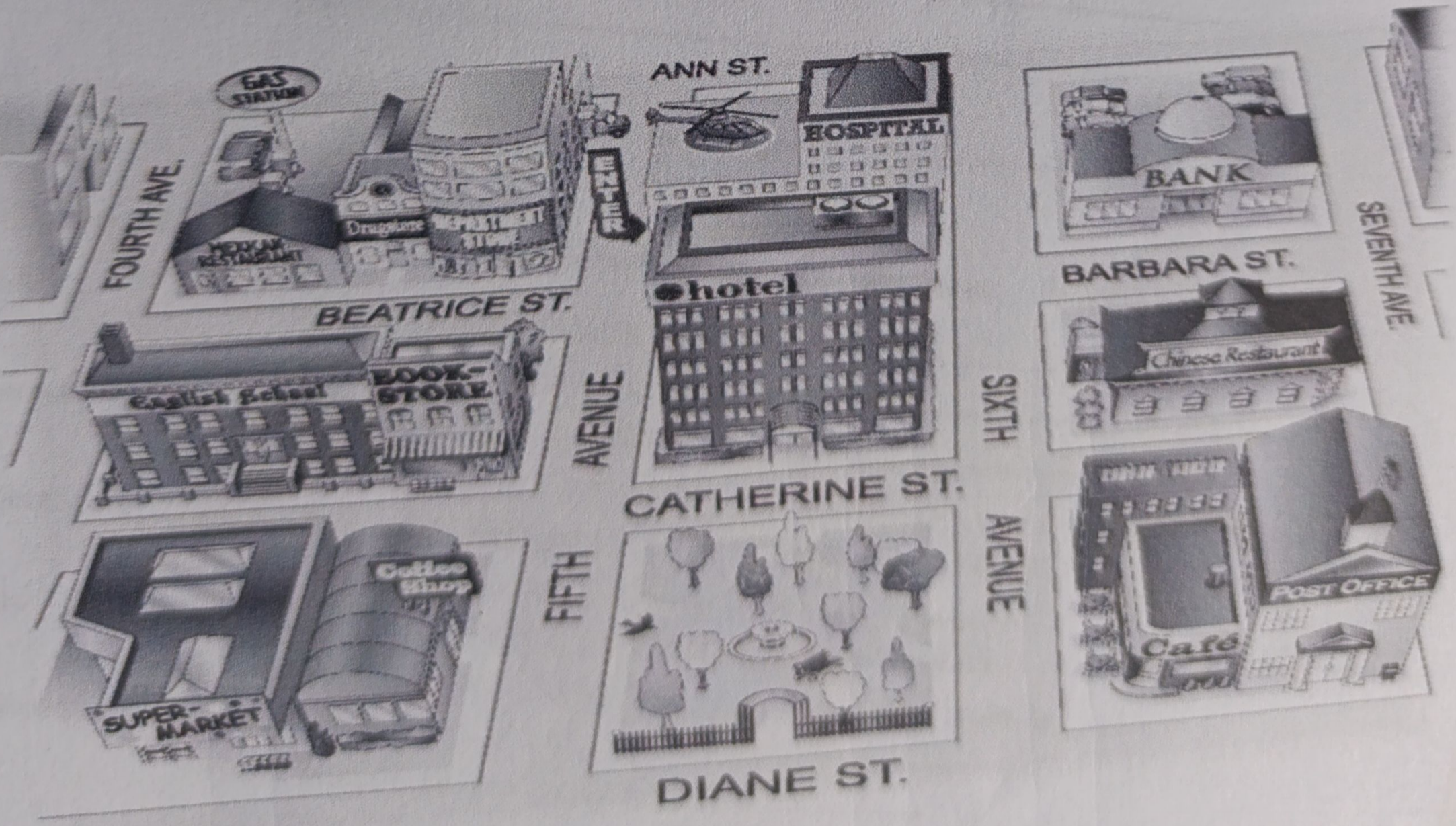

B Where is your school? Draw a map. Then write two sentences.

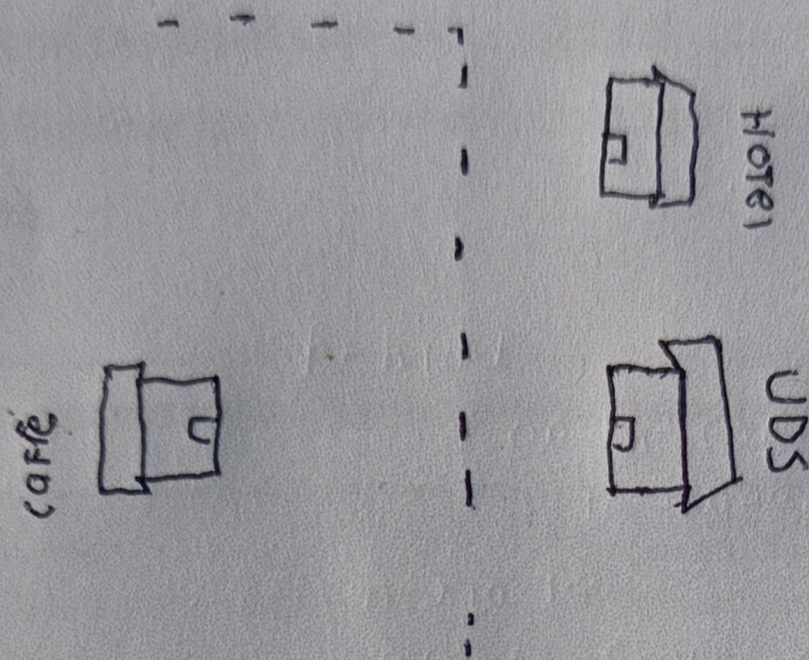

it's next to the HOTEL

it's across from COFFE

3

Where is it?

A Look at the map in Exercise 2 again. Where is each place? Write two sentences.

1. bookstore The bookstore is on the corner of Catherine Street
and Fifth Avenue. It's next to the English school.
2. supermarket It's next to the COFFE SHOP
It's on Diane St.
3. department store It's on the corner of Beatrice St. and Fifth.
It's next to the drugstore.
4. gas station It's behind the Mexican restaurant
It's on the corner of 4th Av. and First St.
5. Chinese restaurant It's between 7th and 6th Av.
It's on Catherine St.
6. hotel It's across from the park.
It's on Catherine St.
7. post office It's next to the coffee
It's on Diane St
8. drugstore It's between Mexican rest. and store.
It's on Beatrice St

Complete the sentences with the opposites.

1. Don't turn *right* on Fifth Avenue. Turn left.
2. The Waverly Hotel isn't *in front of* the concert hall. It's behind it.
3. Don't walk *down* Columbus Avenue. Walk up Columbus Avenue.
4. The museum isn't on the *left*. It's on the right.
5. The Empire State Building is *far* from here, but Central Park is near here.
You can walk there.

4

Complete the conversation. Use the sentences and questions in the box.

- | | |
|--|---|
| <input type="checkbox"/> Next to the café? | <input checked="" type="checkbox"/> Excuse me. Can you help me? |
| <input type="checkbox"/> Is there a post office around here? | <input type="checkbox"/> Where on Diane Street? |
| <input type="checkbox"/> Thanks a lot. | |

Rachel: Excuse me. Can you help me?

Man: Sure.

Rachel: Is there a post office around here?

Man: Yes, there is. It's on Diane Street.

Rachel: Where on Diane Street?

Man: It's on the corner of Diane Street and Seventh Avenue.

Rachel: Next to café?

Man: Yes, that's right. It's right next to the café.

Rachel: Thanks a lot

Man: You're welcome.



Look at the map. Give these people directions. Use the phrases and sentences in the box.

Walk up/Go up . . . Street/Avenue.
Turn left on . . . Street/Avenue.
Walk to . . . Street/Avenue.

Walk down/Go down . . . Street/Avenue.
Turn right on . . . Street/Avenue.
It's on the left/right.

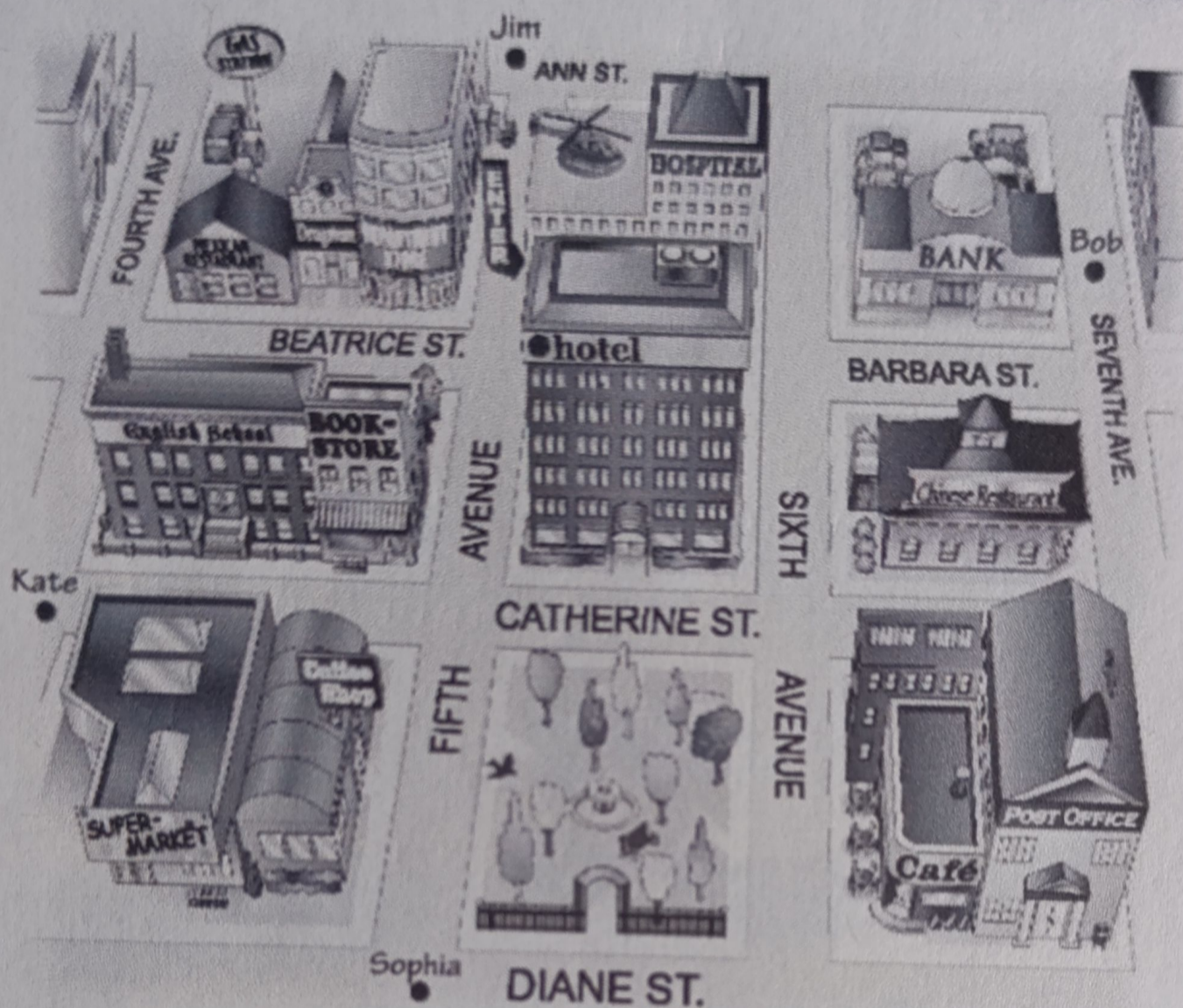

1. Sophia is looking for the Mexican restaurant.

Go up Fifth Avenue. Turn left on Beatrice Street.

Walk to Fourth Avenue. It's on the right.

2. Kate is looking for the post office.

walk 2 blocks and turn on the right one block and
turn left. It's on the corner.

3. Bob is looking for the supermarket.

walk down 3 blocks and turn right. walk 3 blocks
and it's on the corner.

4. Jim is looking for the bank.

walk down the block. Turn left one block and it's
on barbare st