

COSTOS Y PRESUPUESTOS

JORNAL — 8 HORAS

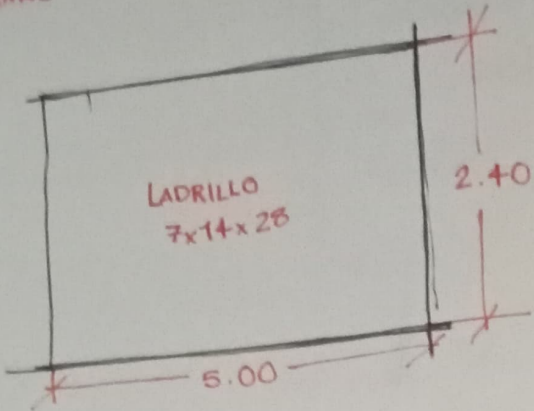

ALBAÑIL → \$ 500.00 - 1.71 = 855
 PEON → \$ 366.00 x 1.71 = 625.86

JOR = 7.00 M²
 AREA = 12 M² x 38.89 → 467 PZAS / 500 M

PRECIO MATERIAL → 467 x \$8 = \$3,736
 PRECIO M.O. DE OBRA → \$1,480
 TOTAL → \$5,216
 COSTO DIRECTO → \$5,216

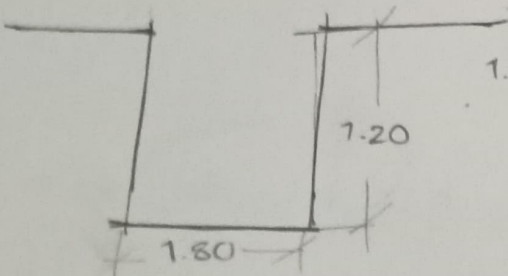

$$1.80 \times 1.8 \times 1.20 = 19.44 \div 2 = 9.72 =$$

PRECIO DE M.O. → \$3,537.62
 PRECIO DIRECTO → \$3,537.62

$$2.375 \times 8 = 19 \text{ M}^3$$

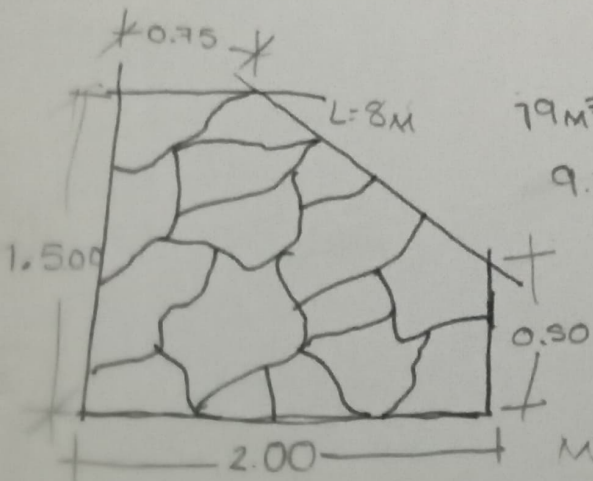

19 M³
 9.5 DIAS

$$M30 = 2,500 \rightarrow \$7916.$$

\$500 x 9.5 = \$4,750
 \$366 x 9.5 = \$3,477

APLANADO EN MURO
 M² = 0.03M

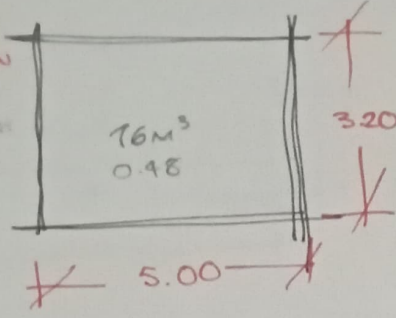

M³ = 0.48M³
 JOR = 12M²

C = 2.00 B₀₁₁₀ = 250
 7m³ = 333

C = 0.286 × 0.48m² = 0.137 = 3
 A = 1.28 × 0.48m³ = \$333
 A₆ = 0.237

MATERIAL → C \$672
 A = \$333
 MO → A \$665
 P \$486.78
 CD → \$2,156.78

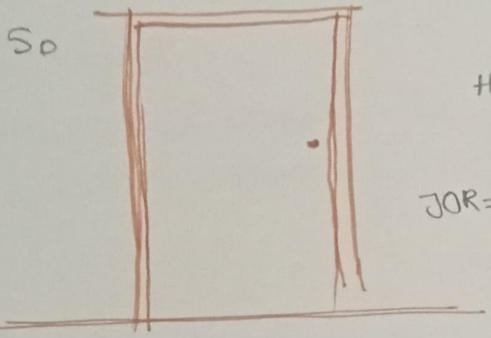

So

HERRERO \$832

JOR = 2 PZAS
 2.5 DIAS

MA - \$890.00 x 5 = \$4,450
 MO → \$2,080.00
 A \$915
 CD → \$7445