



Nombre del Alumno: Frida Lizbeth Reséndiz Salazar

Nombre del tema : Instalacion eléctrica

Parcial : 4

Nombre de la Materia: Diseño arquitectónico

Nombre del profesor: Victor Manuel Santiago Guillrn











Nombre de la Licenciatura: Arquitectura

Cuatrimestre: 7to

UDS

LOCALIZACIÓN

SIMBOLOGÍA

-  Salida de centro
-  Salida arbotante
-  Contacto polarizado duplex
-  Apagador sencillo
-  Apagador de escaleras
-  Cableado por losa
-  Cableado por piso
-  Tablero de carga
-  Medidor
-  Acometida
-  Salida de T.V.

PROYECTO:
DEPARTAMENTOS

PROYECTO

NOMBRE DEL PLANO:
INSTALACION ELECTRICA

D.R.O.:
FRIDA RESENDIZ

FIRMA:  **ESCALA:**
1:75
ACOTACION:
METROS

PLANO:
01 / 02

CLAVE

FECHA: 07 / NOV / 2024

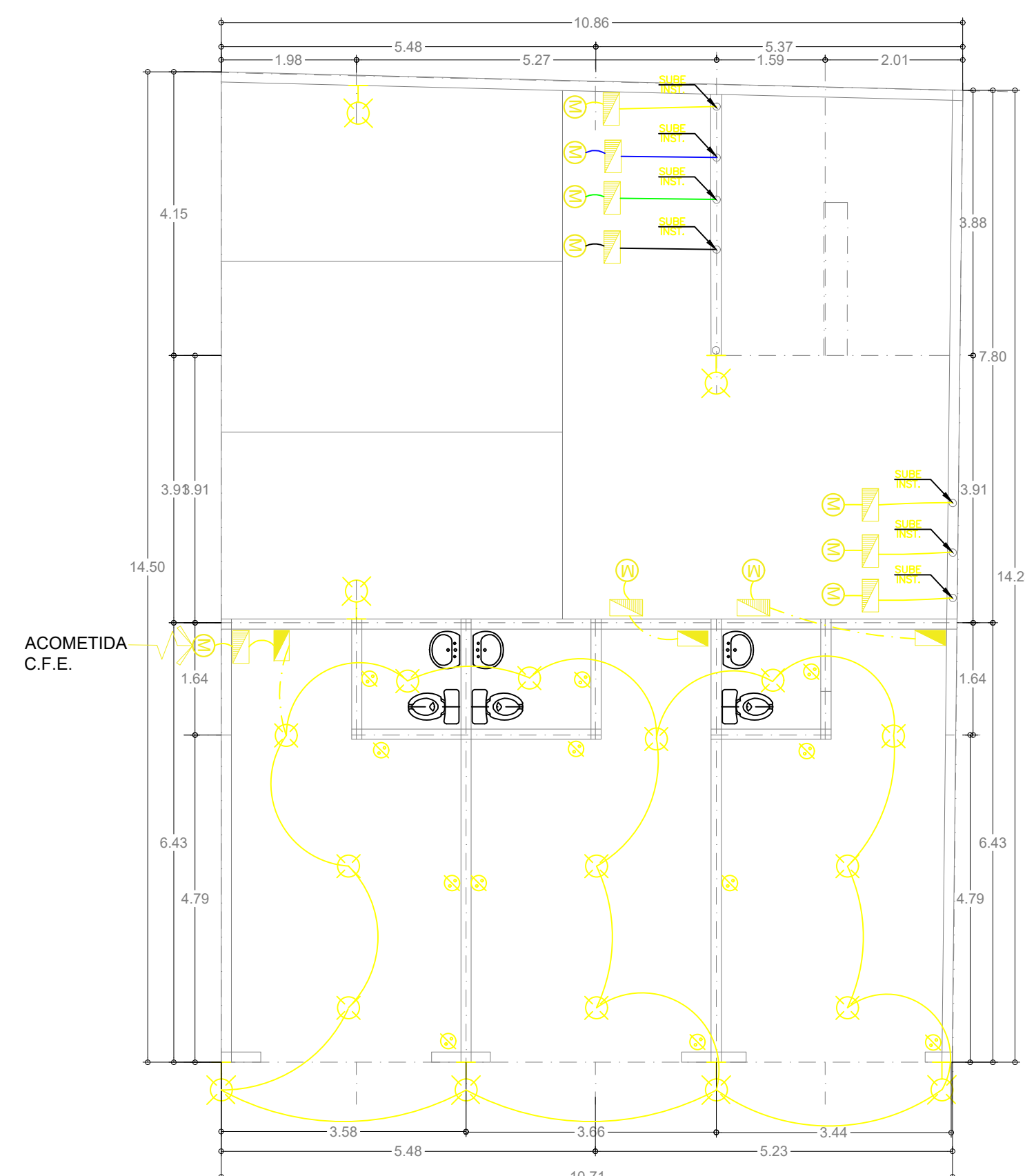

PRIMERA PLANTA
Esc. 1:75

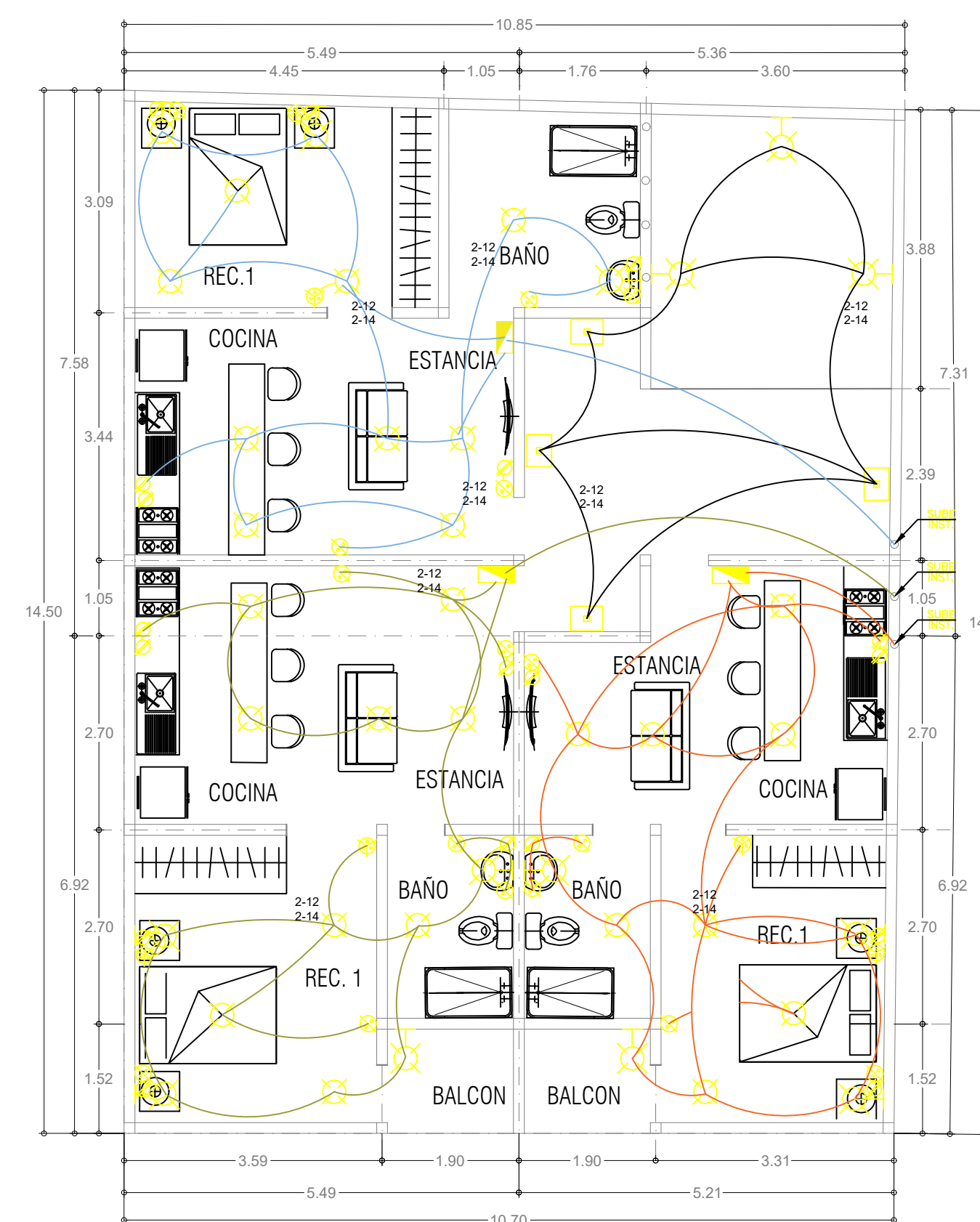

SEGUNDA PLANTA
Esc. 1:75

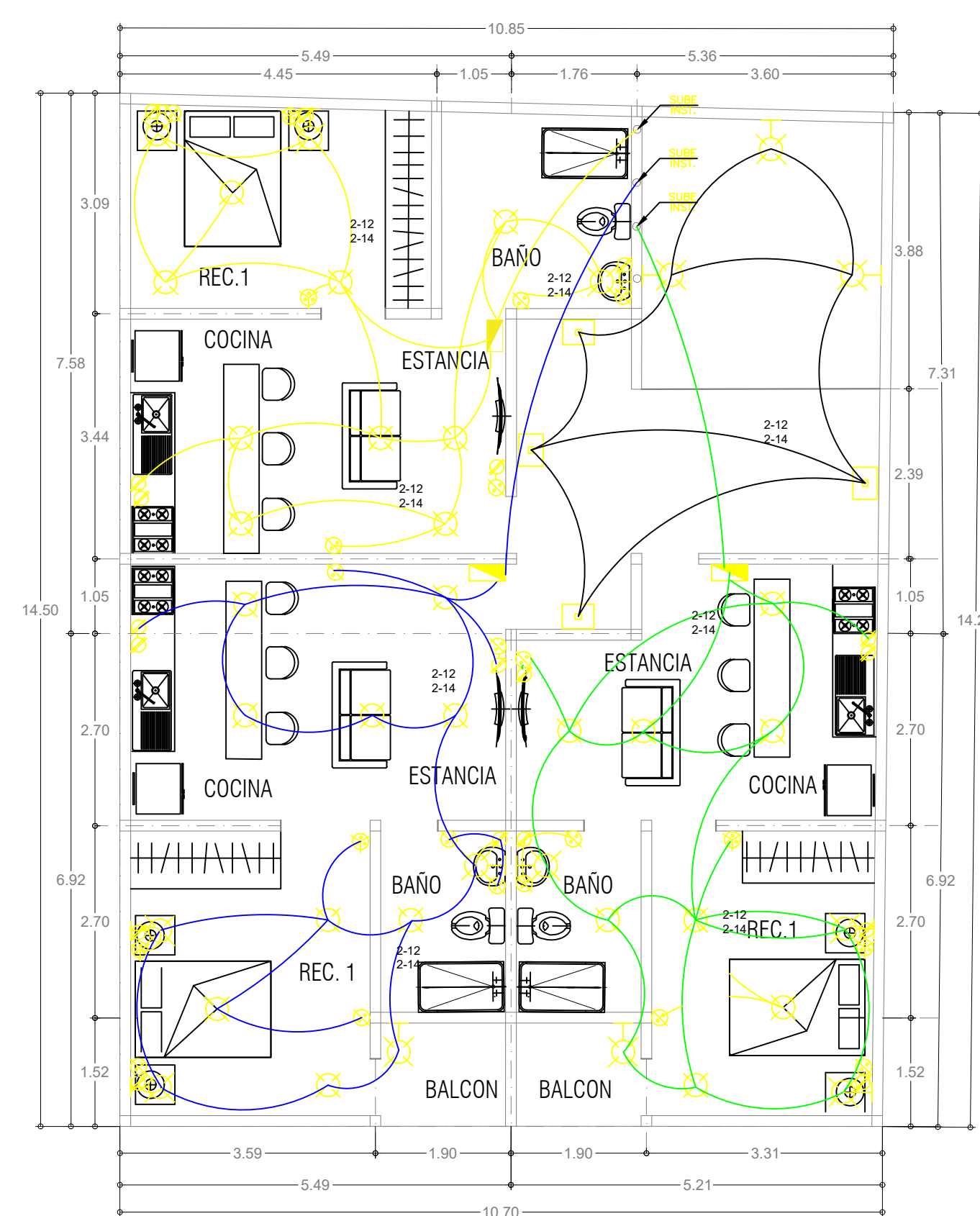

TERCERA PLANTA
Esc. 1:75

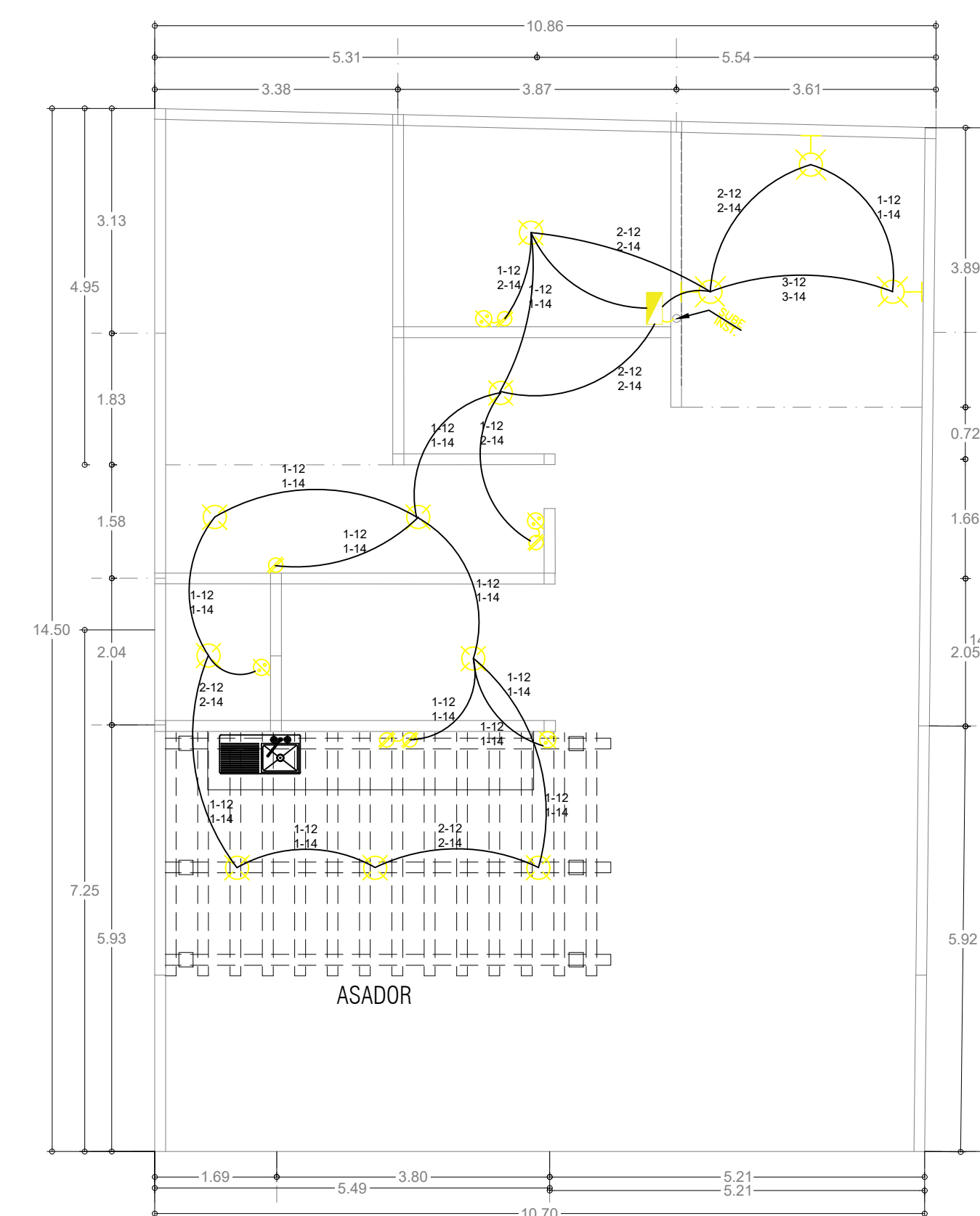

CUARTA PLANTA
Esc. 1:75