

RENATO VILLALOBOS ROBLEDO

PROFESOR: Georgina olivia Vidal  
Alfonso

TRABAJO: actividades

materia : ingles

GRADO: 1 GRUPO: B

COMITÁN DE DOMÍNGUEZ,  
CHIAPAS A 7 de abril del 2024

WORKBOOK

1 Places

**A** Complete these sentences with the correct places.  
Write one letter on each line.

- We need gasoline for the car. Is there a g a s s t a t i o n near here?
- I'm going to go to the g y m. I need some traveler's checks.
- I work at a B o o k s t o r e. I love books, so it's a great job.
- Are you going to the p o s t o f f i c e? I need some stamps.
- We don't have anything for dinner. Let's buy some food at the s u p e r m a r k e t.
- Tomorrow we're going to go to Paris for five days. We're going to stay at an expensive h o t e l.
- I have a stomachache. Can you buy some antacid at the d r u g s t o r e?
- Let's go out for lunch. There's a great Mexican r e s t a u r a n t downtown.

**B** Find and circle the places in part A in the puzzle.

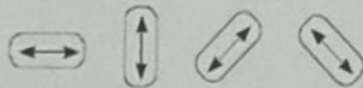

P	H	K	T	Y	W	X	D	C	H	B	S	S	R
D	O	A	W	O	J	R	P	T	O	O	Y	R	E
F	M	S	J	D	R	U	G	S	T	O	R	E	S
S	C	K	T	F	U	Z	V	N	E	K	T	M	T
N	P	W	O	O	H	Y	P	R	L	S	E	L	A
S	K	P	U	K	F	N	S	A	Q	T	N	X	U
K	N	I	B	Y	S	F	U	Y	W	O	M	I	R
G	A	S	S	T	A	T	I	O	N	R	V	G	A
E	B	L	F	W	G	P	C	C	M	E	A	O	N
S	U	P	E	R	M	A	R	K	E	T	K	G	T



2

Look at the map. Complete the sentences with the prepositions in the box.

- |   |   |   |
|---|---|---|
| <input checked="" type="checkbox"/> across from | <input type="checkbox"/> between            | <input checked="" type="checkbox"/> on    |
| <input checked="" type="checkbox"/> behind      | <input checked="" type="checkbox"/> next to | <input type="checkbox"/> on the corner of |

- The English school is on Catherine Street.
- The hospital is Behind the hotel.
- The Mexican restaurant is Between Beatrice Street and Fourth Avenue.
- The bank is on Barbara Street, on the corner of Sixth and Seventh Avenues.
- The bookstore is ACROSS FROM the English school.
- The coffee shop is next to the park.



**3** Where is it?

**A** Look at the map in Exercise 2 again. Where is each place? Write two sentences.

- 1. bookstore The bookstore is on the corner of Catherine Street and Fifth Avenue. It's next to the English school.
- 2. supermarket The supermarket is in front of the bookstore. The supermarket is next to the park.
- 3. department store The department store is behind the bookstore. The department store is between the hospital and the bus station.
- 4. gas station The bus station is behind the English school. The gas station is on the corner of Fourth Street.
- 5. Chinese restaurant The Chinese restaurant is behind the post office. The Chinese restaurant is between the skirt on sun and the hotel.
- 6. hotel The hotel is in front of the hospital. The hotel is between the Chinese restaurant and the post office.
- 7. post office The post office is on the house on Beijing Chinese restaurant.
- 8. drugstore The drugstore is between department store and Mexican restaurant.

**B** Where is your school? Draw a map. Then write two sentences.

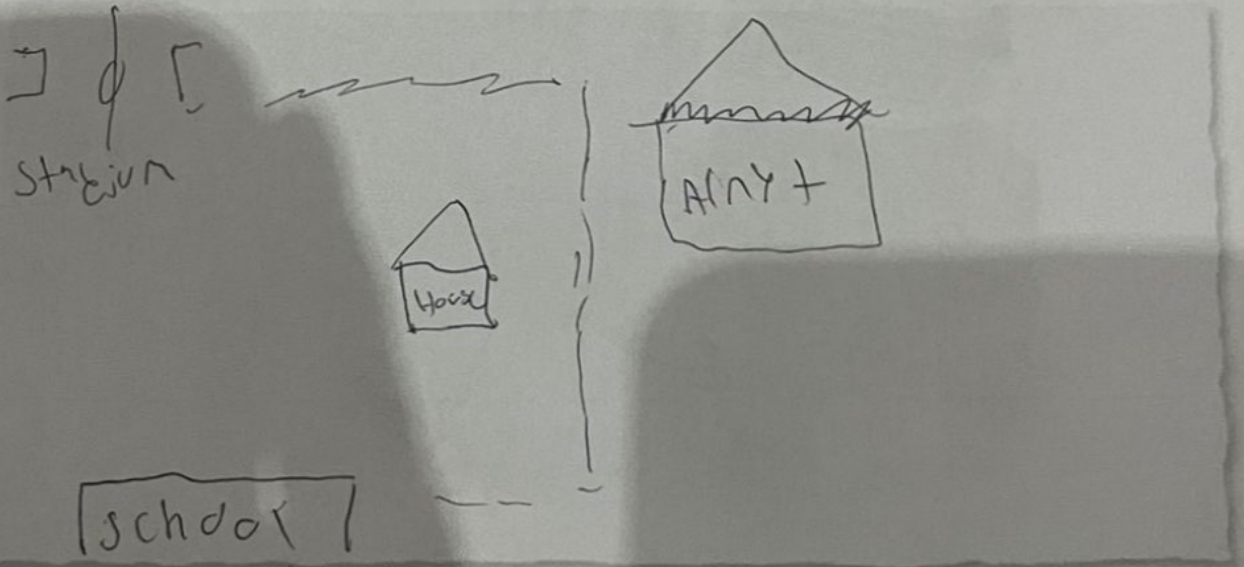

My school is in front of station.  
My school is next to ANY+.

**4** Complete the conversation. Use the sentences and questions in the box.

- |  |   |
|--|---|
| <input type="checkbox"/> Next to the café?                   | <input checked="" type="checkbox"/> Excuse me. Can you help me? |
| <input type="checkbox"/> Is there a post office around here? | <input type="checkbox"/> Where on Diane Street?                 |
| <input type="checkbox"/> Thanks a lot.                       |   |

Rachel: Excuse me. Can you help me?

Man: Sure.

Rachel: Where on Diane Street

Man: Yes, there is. It's on Diane Street.

Rachel: Is there a post office around here

Man: It's on the corner of Diane Street and Seventh Avenue.

Rachel: Right to the café?

Man: Yes, that's right. It's right next to the café.

Rachel: Thanks a lot

Man: You're welcome.

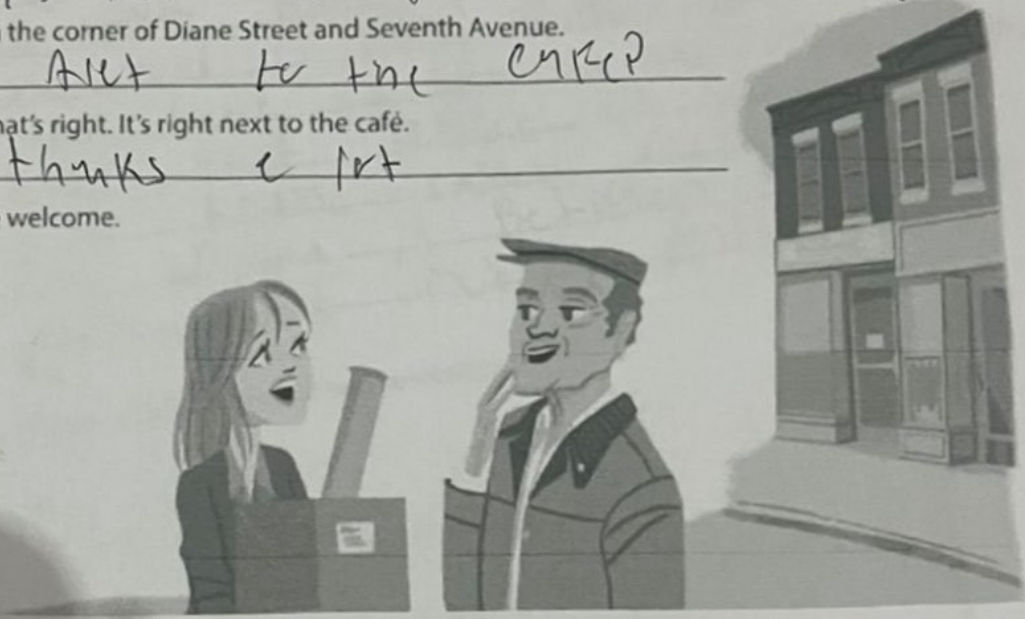

**5** Complete the sentences with the opposites.

1. Don't turn *right* on Fifth Avenue. Turn left.
2. The Waverly Hotel isn't *in front of* the concert hall. It's behind it.
3. Don't walk *down* Columbus Avenue. Walk upside Columbus Avenue.
4. The museum isn't on the *left*. It's on the right.
5. The Empire State Building is *far from* here, but Central Park is near here.  
You can walk there.

**6** Look at the map. Give these people directions. Use the phrases and sentences in the box.

Walk up/Go up . . . Street/Avenue.      Walk down/Go down . . . Street/Avenue.  
 Turn left on . . . Street/Avenue.      Turn right on . . . Street/Avenue.  
 Walk to . . . Street/Avenue.              It's on the left/right.



1. Sophia is looking for the Mexican restaurant.

Go up Fifth Avenue. Turn left on Beatrice Street.

Walk to Fourth Avenue. It's on the right.

2. Kate is looking for the post office.

Walk up Sixth Avenue, then turn right the Post Office is next to the Café

3. Bob is looking for the supermarket.

Walk up Seventh Avenue, then turn left and walk Beatrice St until you reach Fourth Avenue

4. Jim is looking for the bank.

Walk up until Beatrice St then turn right the bank is on the corner of