



Mi Universidad

Tarea Inglés

Kevin Hernandez

Inglés II

Ing. Arreola Jimenez Eduardo Enrique

06 de abril del 2024

7

Imagine you're going to have a party. Complete the invitation. Then draw a map and write directions to the party from your school.

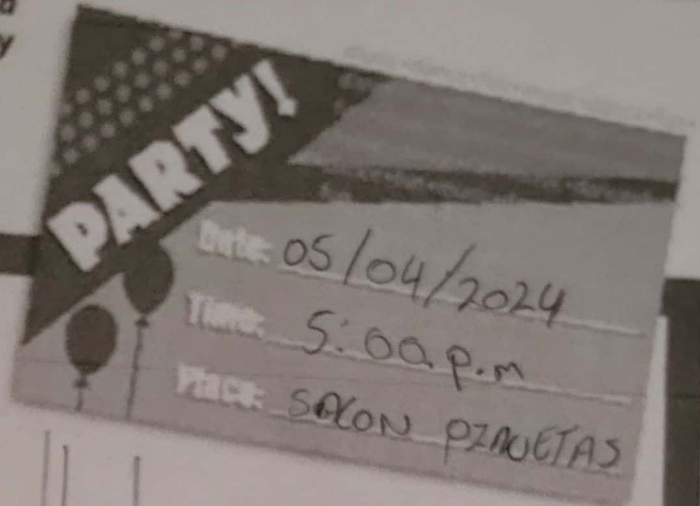

Map to the party

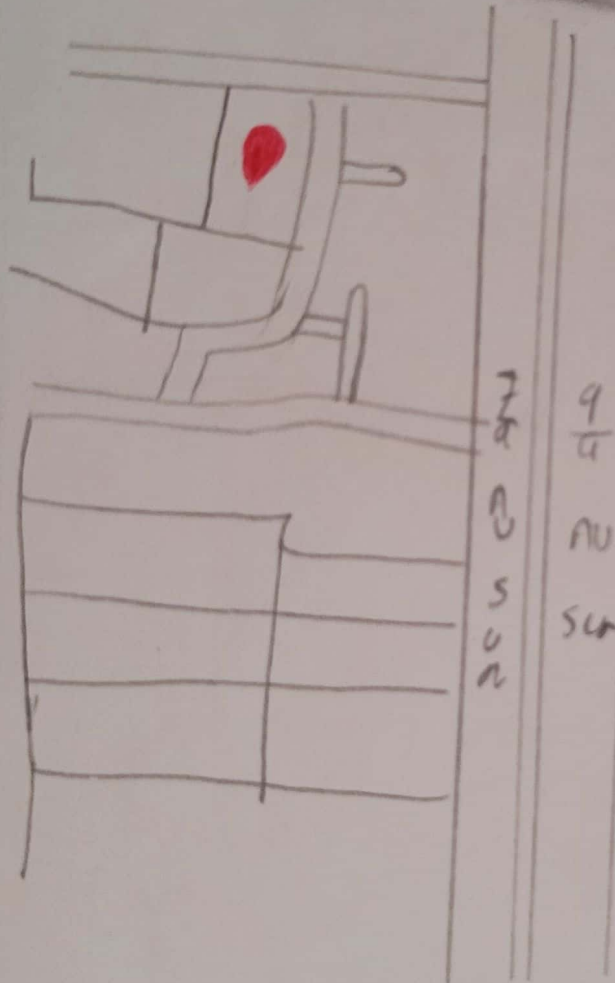

Directions to the party

Start at the school. Then TURN LEFT ON PUEBLO
MADERO HIGHWAY. TURN RIGHT ON LIZAMIZANTO
SUN PTE. TURN LEFT ON 9a AVENIDA SUN TURN
LEFT ON CALLE LAGUNA SHANAJA. TURN RIGHT ON CALLE
MONTIBELLO. WALK UP IN CALLE MONTIBELLO UNTIL CALLE

GUACHIPAZ EN LA IZQUIERDA

3 Where is it?

A Look at the map in Exercise 2 again. Where is each place? Write two sentences.

- 1. bookstore The bookstore is on the corner of Catherine Street and Fifth Avenue. It's next to the English school.
- 2. supermarket THE SUPERMARKET IS ON DIANE STREET IT'S NEXT TO THE COFFEE SHOP
- 3. department store THE DEPARTMENT STORE IS ON THE CORNER OF BEATRICE ST. AND FIFTH AVENUE. IT'S BEHIND THE BOOKSTORE
- 4. gas station THE GAS STATION IS ON FOURTH AVENUE IT'S BEHIND THE MEXICAN RESTAURANT
- 5. Chinese restaurant THE CHINESE RESTAURANT IS ON CATHERINE STREET, BETWEEN SIXTH AND SEVENTH AVENUE
- 6. hotel THE HOTEL IS ACROSS FROM THE PARK IT'S ON THE CORNER OF CATHERINE STREET AND SIXTH AVENUE
- 7. post office THE POST OFFICE IS ON THE CORNER OF DIANE STREET AND SEVENTH AVENUE. IT'S NEXT TO THE CAFE
- 8. drugstore THE DRUGSTORE IS BETWEEN THE MEXICAN RESTAURANT AND THE DEPARTMENT STORE. IT'S BEHIND THE ENGLISH SCHOOL

B Where is your school? Draw a map. Then write two sentences.

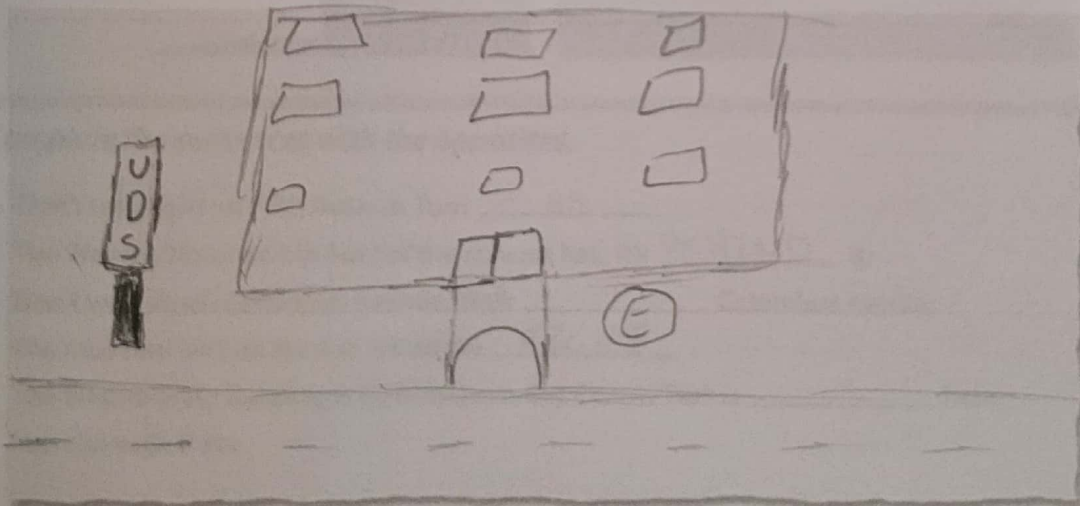

MY SCHOOL IS ON PUERTO MADENO HIGHWAY

Complete the conversation. Use the sentences and questions in the box.

- | | |
|---|---|
| <input checked="" type="checkbox"/> Next to the café? | <input checked="" type="checkbox"/> Excuse me. Can you help me? |
| <input checked="" type="checkbox"/> Is there a post office around here? | <input checked="" type="checkbox"/> Where on Diane Street? |
| <input checked="" type="checkbox"/> Thanks a lot. | |

Rachel: Excuse me. Can you help me?

Man: Sure.

Rachel: IS THERE A POST OFFICE AROUND HERE?

Man: Yes, there is. It's on Diane Street.

Rachel: WHERE ON DIANE STREET?

Man: It's on the corner of Diane Street and Seventh Avenue.

Rachel: NEX TO THE CAFE?

Man: Yes, that's right. It's right next to the café.

Rachel: THANKS A LOT

Man: You're welcome.

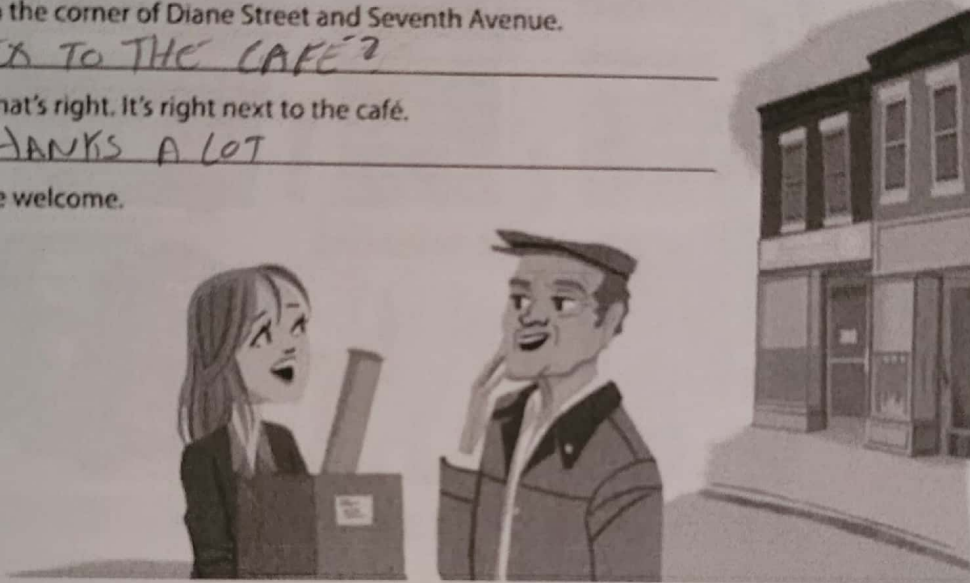

5

Complete the sentences with the opposites.

1. Don't turn *right* on Fifth Avenue. Turn left.
2. The Waverly Hotel isn't *in front of* the concert hall. It's BEHIND it.
3. Don't walk *down* Columbus Avenue. Walk _____ Columbus Avenue.
4. The museum isn't on the *left*. It's on the RIGHT.
5. The Empire State Building is *far from* here, but Central Park is _____ here. You can walk there.

6 Look at the map. Give these people directions. Use the phrases and sentences in the box.

Walk up/Go up . . . Street/Avenue.
 Turn left on . . . Street/Avenue.
 Walk to . . . Street/Avenue.

Walk down/Go down . . . Street/Avenue.
 Turn right on . . . Street/Avenue.
 It's on the left/right.



1. Sophia is looking for the Mexican restaurant.

Go up Fifth Avenue. Turn left on Beatrice Street.

Walk to Fourth Avenue. It's on the right.

2. Kate is looking for the post office.

WALK ON CATHERINE STREET. TURN RIGHT ON SIXTH AVENUE.

TURN LEFT ON DIANE STREET. IT'S NEXT TO THE CAFE

3. Bob is looking for the supermarket.

WALK DOWN SEVENTH AVENUE. TURN RIGHT ON DIANE

STREET. WALK TO FOURTH AVENUE. IT'S ON THE RIGHT.

4. Jim is looking for the bank.

WALK DOWN FIFTH AVENUE. TURN LEFT ON BEATRICE

STREET. WALK TO SIXTH AVENUE. IT'S ON THE CORNER OF BARBARA STREET

2 Look at the map. Complete the sentences with the prepositions in the box.

- | | | |
|---|---|--|
| <input checked="" type="checkbox"/> across from | <input checked="" type="checkbox"/> between | <input checked="" type="checkbox"/> on |
| <input checked="" type="checkbox"/> behind | <input checked="" type="checkbox"/> next to | <input checked="" type="checkbox"/> on the corner of |

- The English school is on Catherine Street.
- The hospital is BEHIND the hotel.
- The Mexican restaurant is ON THE CORNER OF Beatrice Street and Fourth Avenue.
- The bank is on Barbara Street, BETWEEN Sixth and Seventh Avenues.
- The bookstore is NEXT TO the English school.
- The coffee shop is ACROSS FROM the park.

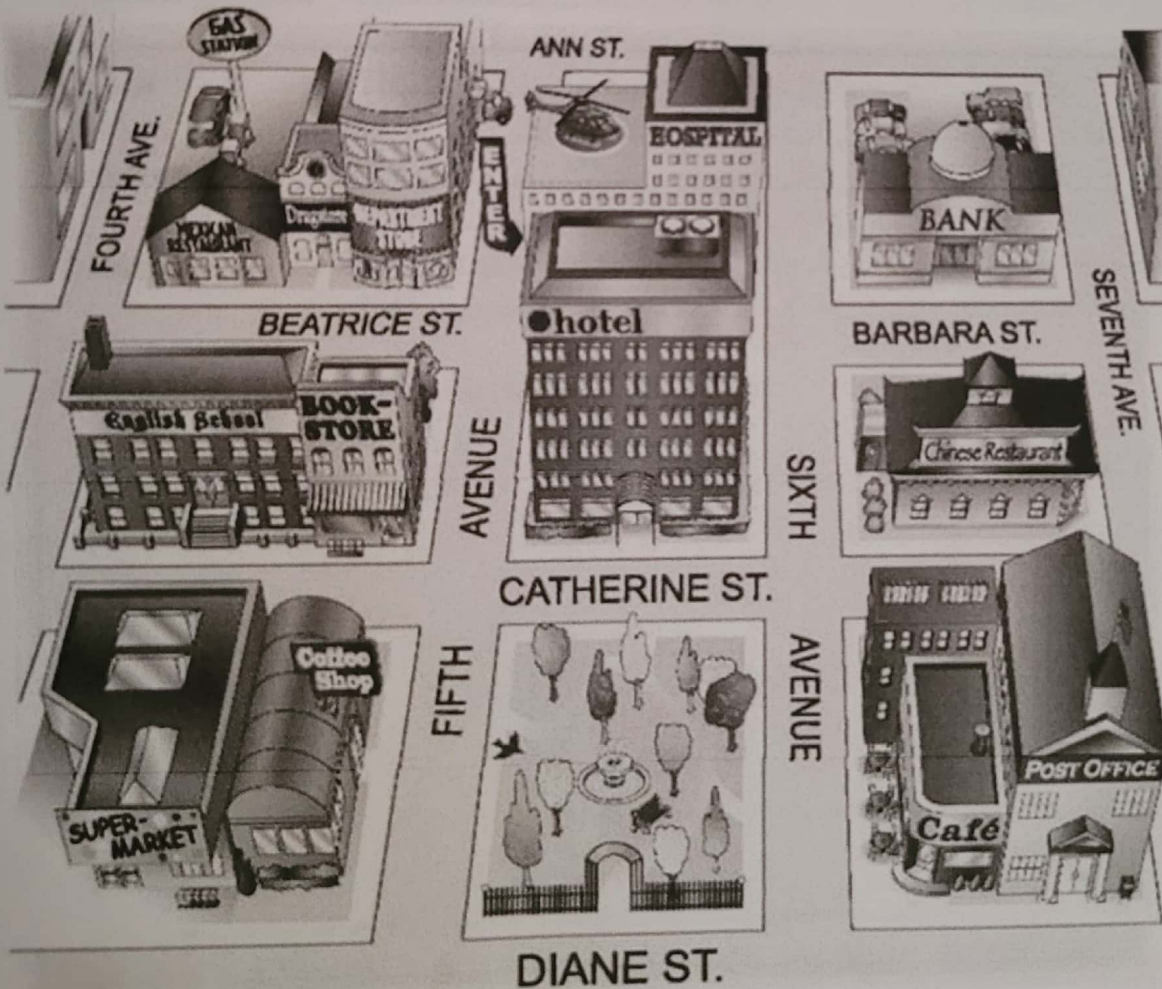

WORKBOOK

1 Places

A Complete these sentences with the correct places. Write one letter on each line.

1. We need gasoline for the car. Is there a g a s s t a t i o n near here?
2. I'm going to go to the B A N K. I need some traveler's checks.
3. I work at a B O O K S T O R E. I love books, so it's a great job.
4. Are you going to the P O S T O F F I C E? I need some stamps.
5. We don't have anything for dinner. Let's buy some food at the S U P E R M A R K E T.
6. Tomorrow we're going to go to Paris for five days. We're going to stay at an expensive H O T E L.
7. I have a stomachache. Can you buy some antacid at the D R U G S T O R E?
8. Let's go out for lunch. There's a great Mexican R E S T A U R A N T downtown.

B Find and circle the places in part A in the puzzle.

