



Sheyla Paola García Aguilar  
Workbook  
Parcial 4  
Inglés 2  
Liliana Rubí Gutiérrez Penagos  
Administración y estrategias de negocios  
Cuatrimestre 2

Complete the conversation. Use the sentences and questions in the box.

- Next to the café?
- Is there a post office around here?
- Thanks a lot.
- Excuse me. Can you help me?
- Where on Diane Street?

Rachel: Excuse me. Can you help me?  
 Man: Sure.  
 Rachel: Is there a post office around here?  
 Man: Yes, there is. It's on Diane Street.  
 Rachel: Where on Diane Street?  
 Man: It's on the corner of Diane Street and Seventh Avenue.  
 Rachel: Next to the café  
 Man: Yes, that's right. It's right next to the café.  
 Rachel: Thanks a lot!  
 Man: You're welcome.

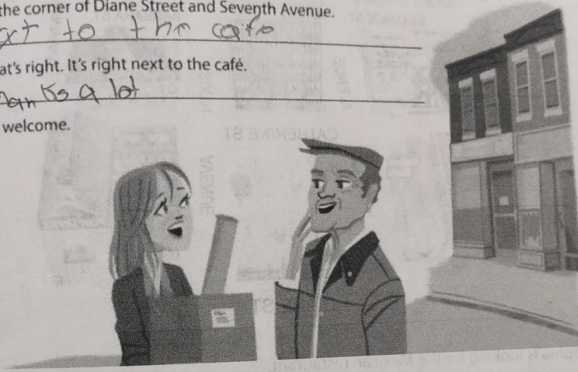

5 Complete the sentences with the opposites.

1. Don't turn right on Fifth Avenue. Turn left.
2. The Waverly Hotel isn't in front of the concert hall. It's behind it.
3. Don't walk down Columbus Avenue. Walk up Columbus Avenue.
4. The museum isn't on the left. It's on the right.
5. The Empire State Building is far from here, but Central Park is near here. You can walk there.

House House House House House House House House

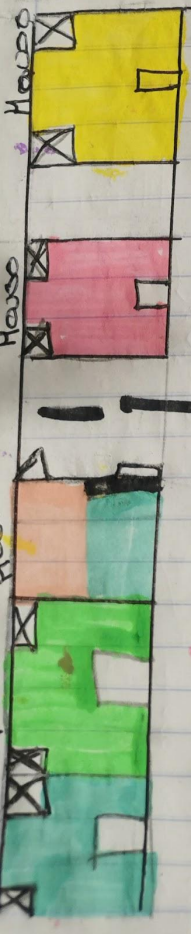

House

House

House

House

House

House

House

House

House

Comitan city

From there, you will have to travel to Santa Rita. Once you arrive, head towards the central park and walk one block up, it is next to a taqueria.

My house



Taqueria



Eventos



PARK