



Sheyla Paola García Aguilar
Workbook
Parcial 4
Inglés 2
Liliana Rubí Gutiérrez Penagos
Administración y estrategias de negocios
Cuatrimestre 2

6 Look at the map. Give these people directions. Use the phrases and sentences in the box.

Walk up/Go up . . . Street/Avenue.
 Turn left on . . . Street/Avenue.
 Walk to . . . Street/Avenue.

Walk down/Go down . . . Street/Avenue.
 Turn right on . . . Street/Avenue.
 It's on the left/right.



1. Sophia is looking for the Mexican restaurant.
 Go up Fifth Avenue. Turn left on Beatrice Street.
 Walk to Fourth Avenue. It's on the right.
2. Kate is looking for the post office.
 walk to catherine st turn right on sixth
 ave. turn left on diane st it's next to the
 coffee shop
3. Bob is looking for the supermarket.
 walk down on seventh Ave. turn right on diane
 st. It's on the corner of fourth and fifth Ave
 it's next to the coffee shop
4. Jim is looking for the bank.
 Jim walks on ann st. turn right on seventh
 ave. Go down on barbara st. it's
 behind the chinese restaurant.

Comitan city

From there, you will have to travel to Santa Rita. Once you arrive, head towards the central park and walk one block up, it is next to a laqueria.



House

House

House

House

House

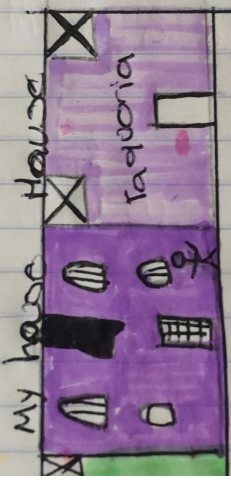

My house

Taquria



Event hall



PARK