



Nombre del alumno: Oliver Fernando Rodas Hernández

Nombre del profesor: Arq. Pedro Alberto García López

Nombre de la materia: Estática de para la Arquitectura

Nombre del trabajo: Ejercicio

Grado: 3 Cuatrimestre 3 unidad

Grupo: Arquitectura

Comitán de Domínguez, Chiapas

9 de julio de 2022.

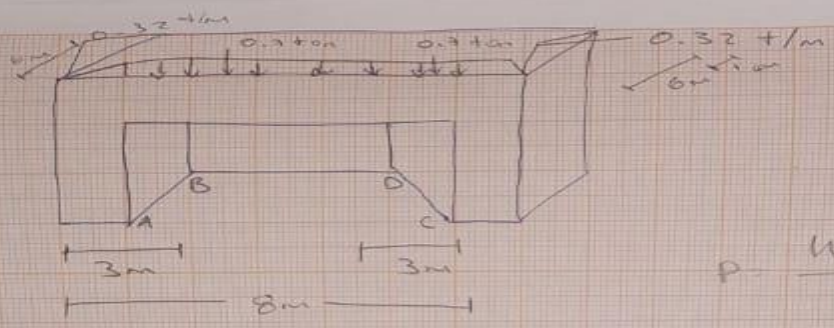

$$p = \frac{W \cdot L}{2}$$

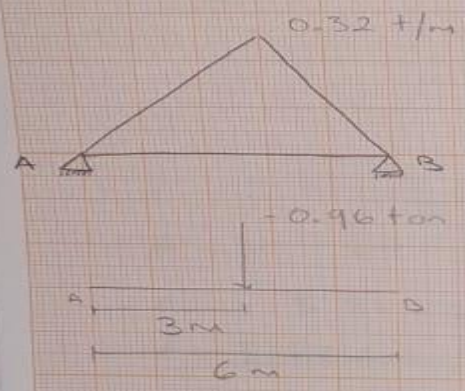

$$-0.32 \times 6 \times \frac{6}{2} =$$

$$\sum M = [-0.96(3m)] + [B(6m)] = 0$$

$$\sum M = -2.88 + 6B = 0$$

$$\sum M = -2.88 / 6m = 0$$

$$B = -0.48 \text{ ton} \rightarrow B = 0.48 \text{ ton}$$

$$\sum F_y = (-0.96 + 0.48)$$

$$A = -0.48 \text{ ton}$$

$$\sum M = [-0.96 \text{ ton}(3m)] + [-1.10 \text{ ton}(5m)] + [0(6m)] = 0$$

$$\sum M = -8.38 \text{ ton} + 0.6m = 0$$

$$\sum M = -8.38 \text{ ton} / 6m = 0$$

$$\sum M = -1.39 \text{ ton} \rightarrow D = 1.39 \text{ ton}$$

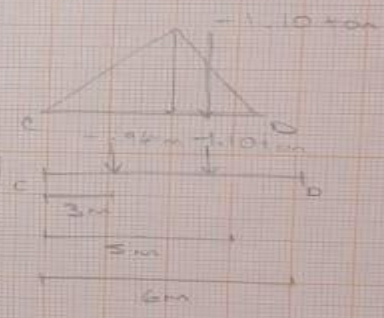

$$\sum F_y = -0.96 - 1.10 + 1.39$$

$$C = -0.67$$

$$C = 0.67 \text{ ton}$$

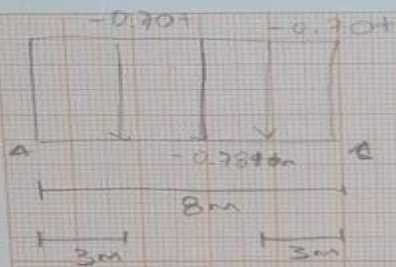

$$0.78 (8m) = 6.24 \text{ ton}$$

$$UP = 8/2 = 4$$

$$EM = [-0.70 + (3m)] + [-6.24 + (4m)] + [-0.70 + (5m)] + [c (8m)] - 0$$

$$EM = -\frac{30.56 + c}{8m} = 0$$

$$EM = -3.82c = 0 \rightarrow c = 3.82 \text{ ton/}$$

$$A = -0.70 - 6.24 - 0.70 + 3.82 = 0$$

$$A = -7.64 + 3.82 = 0$$

$$A = -3.82 = 0$$

$$A = 3.82 \text{ ton/}$$

3.82
3.82
- 0.48
0.48
0.67
1.39

→ $\boxed{\sum T = 9.7 \text{ ton}}$