



Nombre de alumno: JOSE MARTIN
JIMENEZ LÓPEZ

Nombre del profesor: Erika Adriana Iris
Gordillo Rojas

Nombre del trabajo: Activity 2

Materia: Inglés 2

Grado: 2

Grupo: C

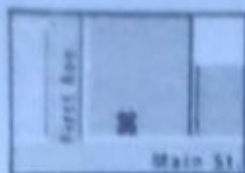

on

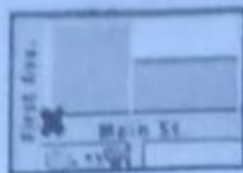

on the corner of

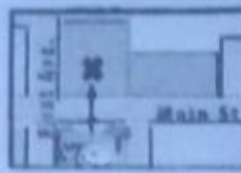

across from

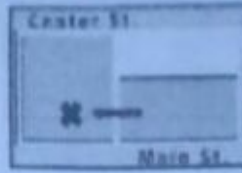

next to



between

Solve

The department store is **on** Main Street.
It's **on the corner of** Main and First.
It's **across from** the park.

It's **next to** the bank.
The bank is **between** the department store **and** the restaurant.

Look at the map and complete the sentences. Then compare with a partner.



- The coffee shop is on Second Avenue. It's next to the shoe store.
 - The movie theater is on the corner of Park and Main. It's across from the park.
 - The gas station is on the corner of the parking lot. It's on First and Center. on the corner of
 - The post office is on Center and Second. It's next to the hospital, next to
 - The bank is between the restaurant and the department store. It's on Main Street.
- the corner of.

- across from between on
 behind next to on the corner of

- The English school is on Catherine Street.
- The hospital is behind the hotel.
- The Mexican restaurant is on the corner of Beatrice Street and Fourth Avenue.
- The bank is on Barbara Street, between Sixth and Seventh Avenues.
- The bookstore is next to the English school.
- The coffee shop is across from the park.

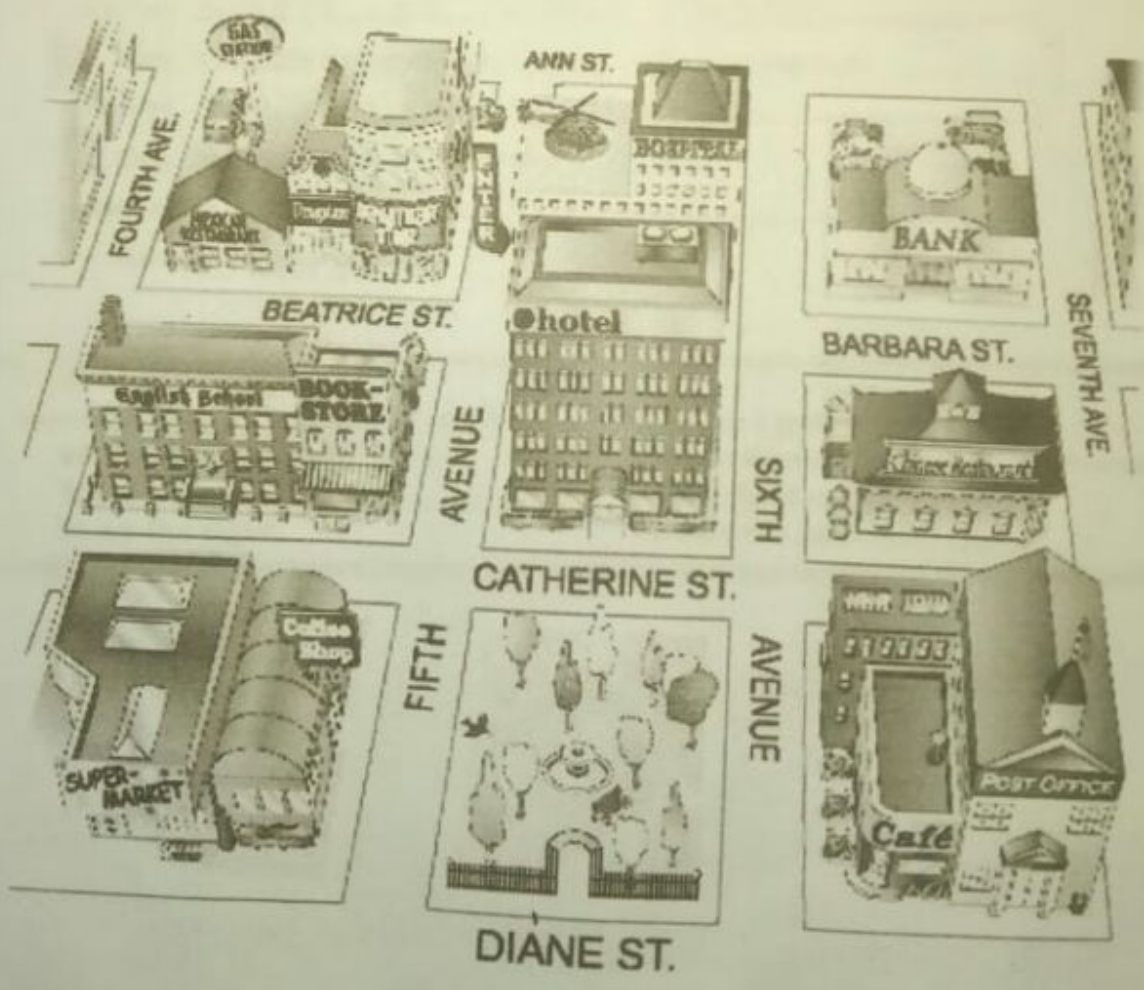

- | | |
|---|---|
| <input type="checkbox"/> Next to the café? | <input checked="" type="checkbox"/> Excuse me. Can you help me? |
| <input checked="" type="checkbox"/> Is there a post office around here? | <input type="checkbox"/> Where on Diane Street? |
| <input type="checkbox"/> Thanks a lot. | |

Rachel: Excuse me. Can you help me?

Man: Sure.

Rachel: Is there a post office around here?

Man: Yes, there is. It's on Diane Street.

Rachel: Where on Diane Street?

Man: It's on the corner of Diane Street and Seventh Avenue.

Rachel: Next to the café.

Man: Yes, that's right. It's right next to the café.

Rachel: Thanks a lot.

Man: You're welcome.

Directions

How do I get to Rockefeller Center?

Walk up/Go up Fifth Avenue.

Turn left on 49th Street.

It's **on the right.**

How can I get to Bryant Park?

Walk down/Go down Fifth Avenue.

Turn right on 42nd Street.

It's **on the left.**

Walk up/Go up . . . Street/Avenue.
Turn left on . . . Street/Avenue
Walk to . . . Street/Avenue.

Walk down/Go down . . . Street/Avenue.
Turn right on . . . Street/Avenue
It's on the left/right.



1. Sophia is looking for the Mexican restaurant.

Go up Fifth Avenue. Turn left on Beatrice Street.

Walk to Fourth Avenue. It's on the right.

2. Kate is looking for the post office.

Go up Catherine St. turn right on Avenue

walk to Diane St. It's on the left a net to cafe

3. Bob is looking for the supermarket.

Go up seventh ave. turn right on Diane St

walk to fourth avenue. It's on the right.

4. Jim is looking for the bank.
