



**Nombre de alumno:** Elioenai David López  
Espinosa

**Nombre del profesor:** Pedro Alberto Garcia

**Nombre del trabajo: CARGAS VIVAS,  
MUERTAS Y ACCIDENTALES**

**Materia: ANALISIS DE MATERIALES**

**Grado: 5to**

**Grupo: "A"**

Comitán de Domínguez Chiapas a 21 de Enero de 2022.

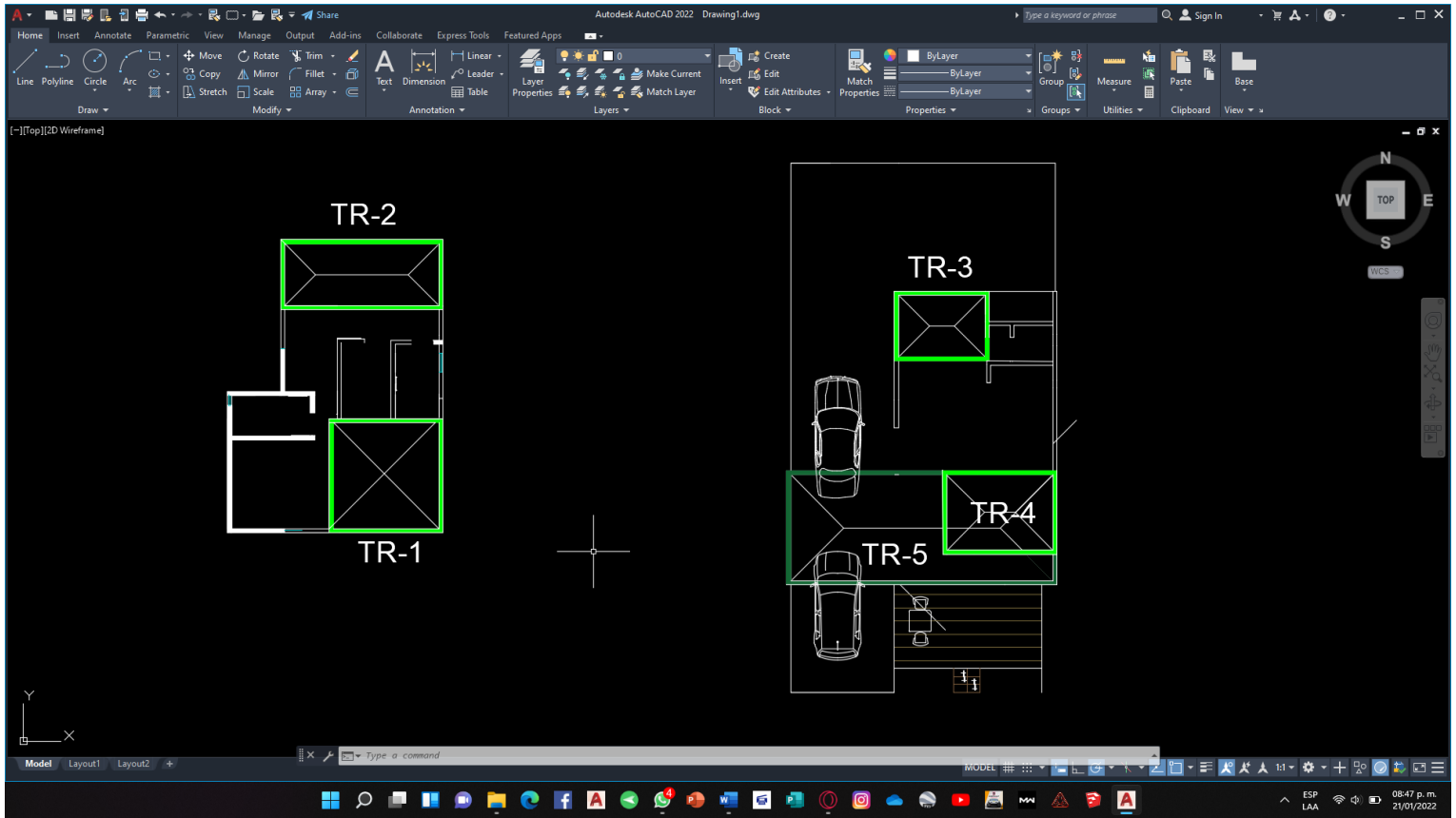

**TR-1**

$P_h = 2/12 = 9/12 = 0.23 \text{ m} = 0.23 \text{ m}$   
 $A = \frac{(a+b)(h)}{2} = \frac{(4+4)(4)}{2} = 4 \text{ m}^2$   
 $P = (A \times \rho) = (4 \text{ m}^2) (610 \text{ kg/m}^2) = 2,440 \text{ kg}$   
 $P = 2.44 \text{ TOB} \#$   
 $h = P/E + r$   
 $r = 11.7/200 \text{ m} = 0.0585 \text{ m}$   
 $h = 8/170 + 0.0585 = 0.0729 = 0.10 \text{ m}$

**TR-2**

$P_h = 0.19$   
 $A = \frac{(a+b)(h)}{2} = \frac{(1.175+3.5)(1.175)}{2} = 4.98 \text{ m}^2$   
 $A = 4.98$   
 $h = 8/170 + 0.0254 = 0.055 = 0.054 \text{ m} \#$   
 $P = (4.98 \text{ m}^2) (610 \text{ kg/m}^2) = 3,037.8 \text{ kg} = 3.0378 \text{ TOB} \#$   
 $P = 841.8 \text{ kg} = 0.8418 \text{ TOB} \#$   
 $A = \frac{(a+b)(h)}{2} = \frac{(5.85+3.5)(1.175)}{2} = 4.98 \text{ m}^2$   
 $h = 11.7/170 + 0.0254 = 0.094 = 0.10 \text{ m}$   
 $P = 4.98 \text{ m}^2 \times 610 \text{ kg/m}^2 = 3,037.8 \text{ kg} = 3.0378 \text{ TOB}$

**TR-3**

$A = \frac{(a+b)(h)}{2} = \frac{(1.165+3.28)(1.35)}{2} = 2.19 \text{ m}^2$   
 $A = 2.19 \text{ m}^2$   
 $h = 6.56/170 + 0.0254 = 0.053 \text{ m}$   
 $P = (2.19 \text{ m}^2) (610 \text{ kg/m}^2) = 1,335.9 \text{ kg} = 1.3359 \text{ TOB}$   
 $A = \frac{(a+b)(h)}{2} = \frac{(1.165+3.28)(1.35)}{2} = 2.19 \text{ m}^2$   
 $h = 6.56/170 + 0.0254 = 0.053 \text{ m}$   
 $P = (2.19 \text{ m}^2) (610 \text{ kg/m}^2) = 1,335.9 \text{ kg} = 1.3359 \text{ TOB}$

**TR-4**

$A = \frac{(a+b)(h)}{2} = \frac{(1.425+4)(2.85)}{2} = 2.81 \text{ m}^2$   
 $A = 2.81 \text{ m}^2$   
 $h = 8/170 + 0.0254 = 0.07 \text{ m}$   
 $P = (2.81 \text{ m}^2) (610 \text{ kg/m}^2) = 1,714.1 \text{ kg} = 1.7141 \text{ TOB}$   
 $A = \frac{(a+b)(h)}{2} = \frac{(2.85+1.425)(2.85)}{2} = 2.81 \text{ m}^2$   
 $A = 2.81 \text{ m}^2$   
 $h = (5.7)/170 + 0.0254 = 0.058 = 0.06 \text{ m}$   
 $P = (2.81 \text{ m}^2) (610 \text{ kg/m}^2) = 1,714.1 \text{ kg} = 1.7141 \text{ TOB}$

TR-5

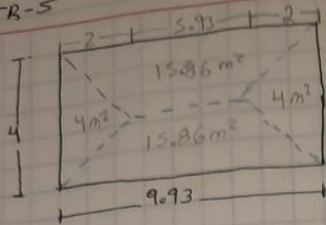

$$A = 4(2)/2 = 4m^2$$

$$h = 8/170 + 0.0254$$
$$h = 0.072m$$

$$P = (4m^2)(610kg/m^3)$$
$$P = 2440kg = 2.44TON$$

$$A = 9.93m + 5.93m (2)/2$$
$$A = 15.86m^2$$

$$h = 19.86/170 + 0.0254$$
$$h = 0.1422 = 15m$$

$$P = (15.86m^2)(610kg/m^3)$$
$$P = 9,674.6kg = 9.6746TON$$