



**Nombre de alumno: Enrique Fabian Jimenez
fonseca**

Nombre del profesor: Pedro Alberto García

Nombre del trabajo: Áreas tributarias y trabes

Materia: análisis estructural

Grado: 5to

PASIÓN POR EDUCAR

Grupo:

Comitán de Domínguez Chiapas a 21 de enero de 2021.

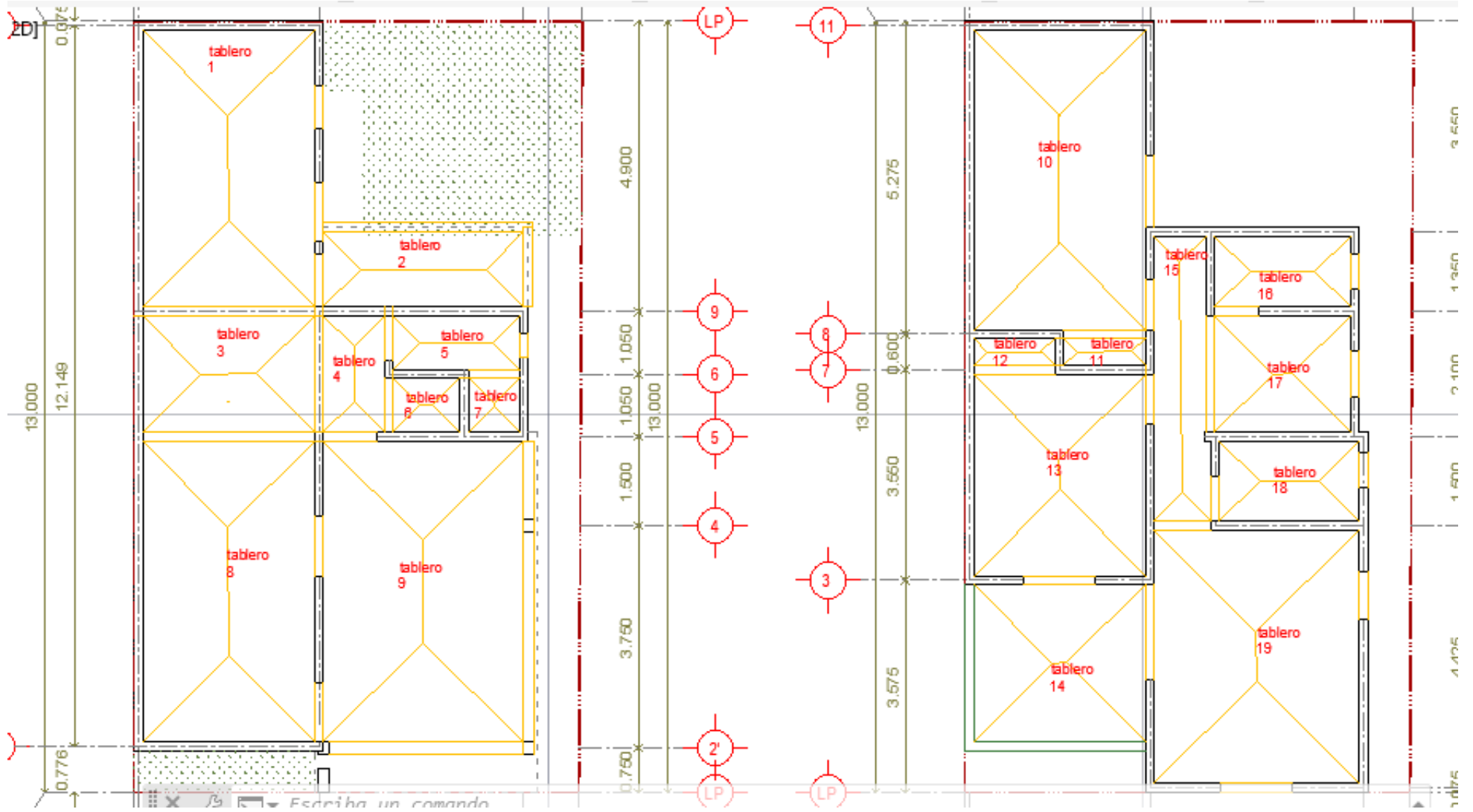

trabes

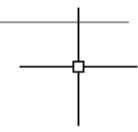
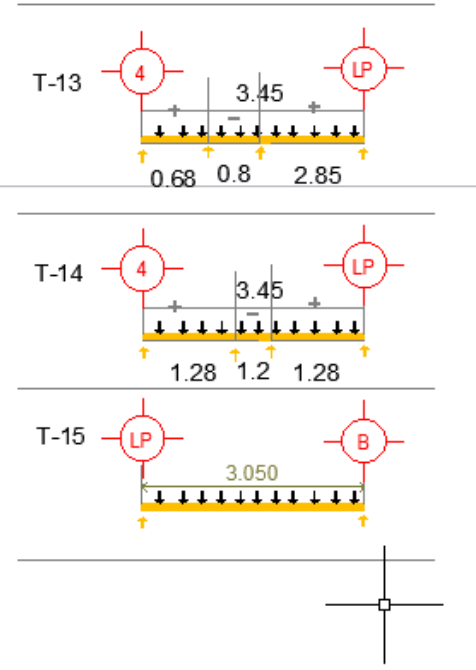
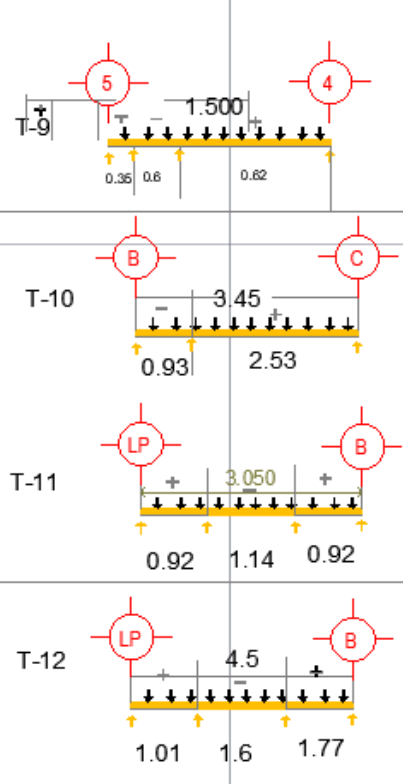
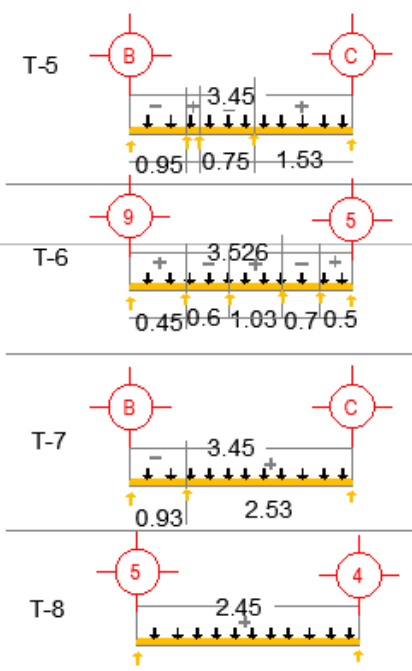
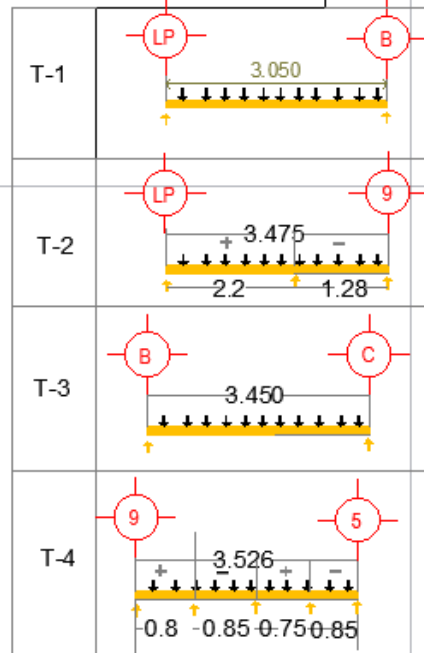

1	tablero	perimetro	espesor	tipo	area tributarea	peso	total	
2	1	15.14	0.129058824	triangular	2.0952	620	1299.024	
3	1	15.14	0.129058824	trapesoidal	4.6718	620	2896.516	
4	2	9.3	0.094705882	triangular	0.4064	580	235.712	
5	2	9.3	0.094705882	trapesoidal	1.7452	580	1012.216	
6	3	9.69	0.097	triangular	0.9506	580	551.348	
7	3	9.69	0.097	trapesoidal	1.872	580	1085.76	
8	4	5.96	0.075058824	triangular	0.2652	580	153.816	
9	4	5.96	0.075058824	trapesoidal	0.739	580	428.62	
10	5	6.04	0.075529412	triangular	0.2025	580	117.45	
11	5	6.04	0.075529412	trapesoidal	0.7515	580	435.87	
12	6	4.04	0.063764706	triangular	0.2025	580	117.45	
13	6	4.04	0.063764706	trapesoidal	0.3015	580	174.87	
14	7	3.5	0.060588235	triangular	0.1806	580	104.748	
15	7	3.5	0.060588235	trapesoidal	0.2019	580	117.102	
16	8	15.94	0.133764706	triangular	2.0952	620	1299.024	
17	8	15.94	0.133764706	trapesoidal	5.2508	620	3255.496	
18	9	16.8499	0.139117059	triangular	2.8056	620	1739.472	
19	9	16.8499	0.139117059	trapesoidal	5.695	620	3530.9	
20	10	15.8932	0.133489412	triangular	2.1066	790	1664.214	
21	10	15.8932	0.133489412	trapesoidal	5.217	790	4121.43	
22	11	3.645	0.061441176	triangular	0.0506	610	30.866	
23	11	3.645	0.061441176	trapesoidal	0.2582	610	157.502	

